



CITY OF
NEWARK

Development Update

By Community Development Department

June 28, 2022



FMC Willow and Grand Park

Public Hearing PC July 12th

- 279 Residential Units
- 90 Affordable Housing units
- Transit Station Parcel
- Amendment of Grand Park





Mowry Village

- 7400 Mowry Avenue (west of Silliman Center)
- 203-unit subdivision consisting of all single-family residences

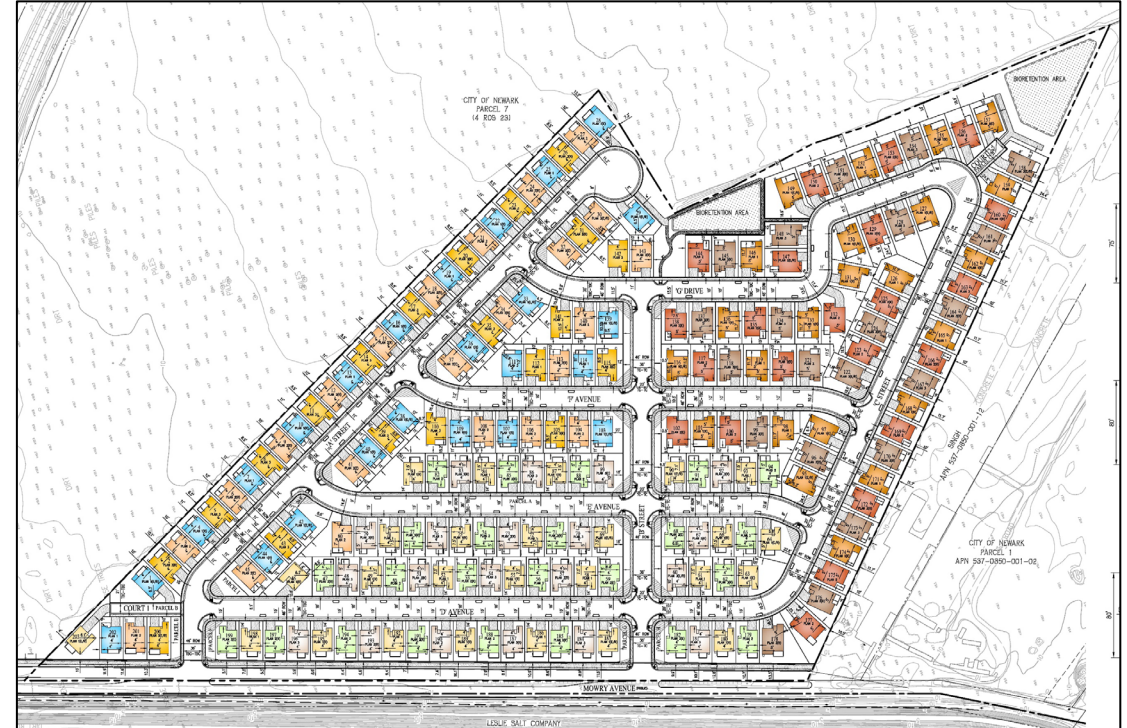



AC Marriott

- 39888 Balentine Drive (Nijo Castle Property)
- 132 room hotel with 2 ballrooms, guest amenities, and 96-space parking lot





Cedar Homes by Robson Homes

- 38370 Cedar Blvd
- 126-unit subdivision consisting of 3-story single-family homes and duplexes

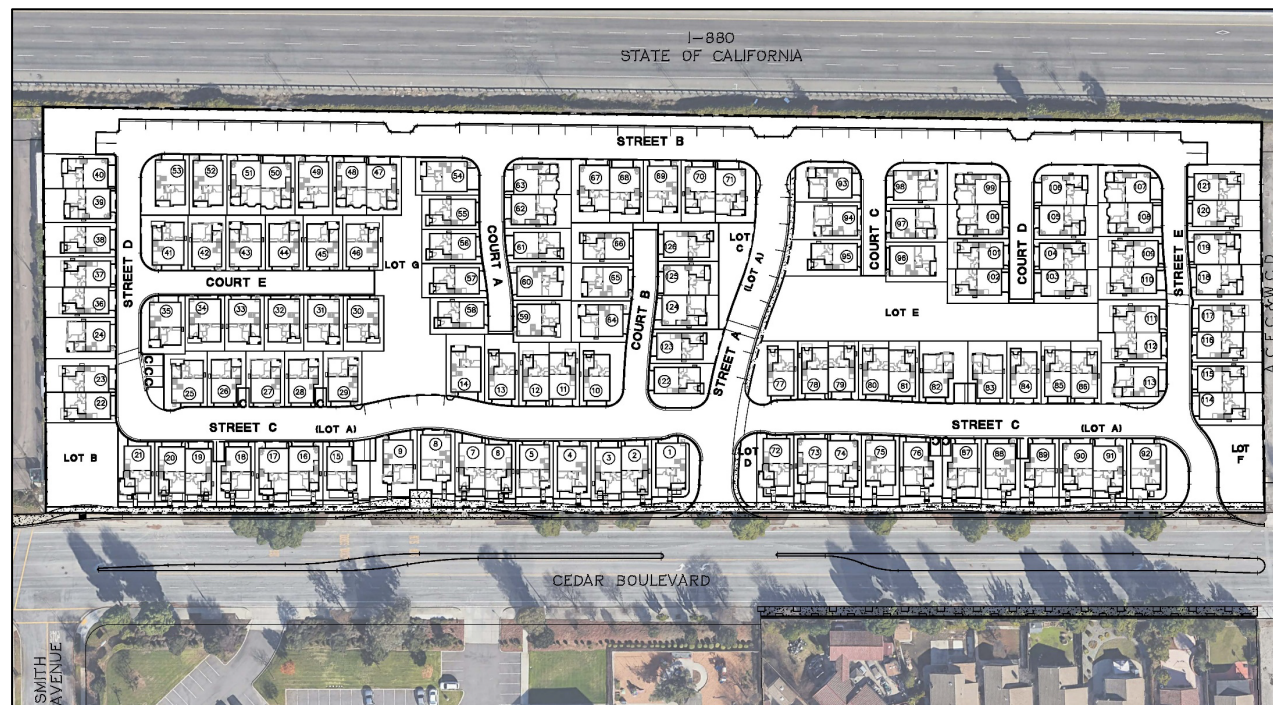



Mulberry Condos

- 36952 Mulberry Street
- 8 for-sale units within 4 two-story buildings
- Located in Old Town Newark





Jarvis Office Building

- 6953 Jarvis Avenue
- 41,000 sq. ft. 6-story office building
- Two stories of underground parking and four stories of office space above





Lepakshi Homes

- 6781 Thornton Avenue
- 83 condo units within 2 4-story buildings
- Building north of Olive Street will include 5 live/work units
- Each building will include below grade and above grade parking
- Preliminary Review





Prologis Industrial Building

- 6750 Central Avenue
- New 312,000 sq. ft. industrial building with 30,650 sq. ft. of office space
- Adjacent to Central Avenue Overpass Project
- Preliminary Review





Gateway Mixed Use

- 37455 Willow Street
- Mixed-use building with 132 condo units and 12,370 sq. ft. of commercial space
- Former CUP Approval for Willow Hotel
- Preliminary Review





Cedar Townhomes by Waymark

- 38600 Cedar Blvd
- 80-unit subdivision consisting of 3-story attached townhomes
- Preliminary Review

